

1) PB1: h=90mm, L=1320, A=78@50, B=78@80, C=600
 2) PB2: h=90mm, L=880, A=78@50, B=78@80, C=600

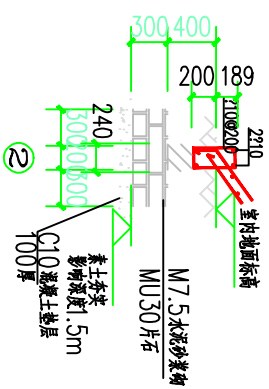

(1)

(2)

(3)

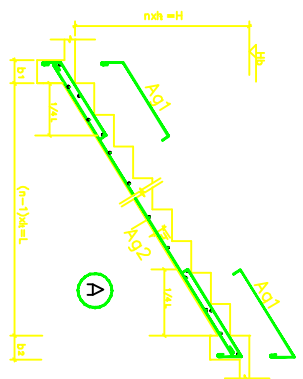

(4)

平法标注: TB; h=g; Ag1/Ag2
 Ag1/Ag2 上下水平钢筋间距6@200
 垂直方向间距为Ag1, 垂直间距为Ag2. 间距为10@200/10@50, 标注为Ag1/